

Cabinet

Date: Monday 7th January 2013
Time: 2.00 pm
Venue: Council Chamber, Municipal Buildings, Earle Street,
Crewe CW1 2BJ

9. **Key Decision 39 - Crewe Railway Exchange - Site Assembly and Land in Unknown Ownership** (Pages 1 - 2)

Attached is a revised plan of the Crewe Railway Exchange site – updated to show the area mentioned in paragraph 2.1 of the report as edged green

This page is intentionally left blank

Crewe Rail Exchange

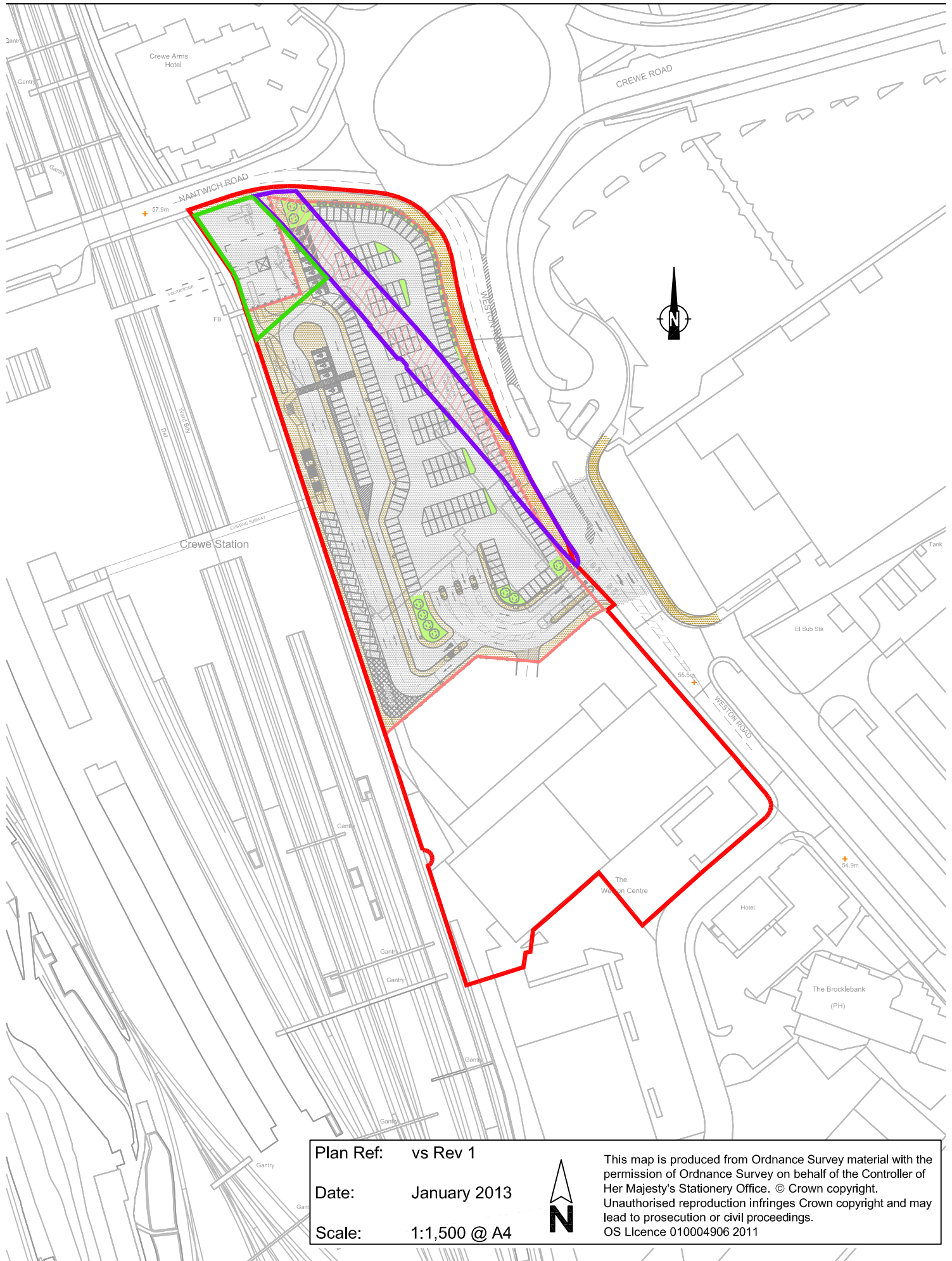

Plan Ref: vs Rev 1

Date: January 2013

Scale: 1:1,500 @ A4



This map is produced from Ordnance Survey material with the permission of Ordnance Survey on behalf of the Controller of Her Majesty's Stationery Office. © Crown copyright. Unauthorised reproduction infringes Crown copyright and may lead to prosecution or civil proceedings. OS Licence 010004906 2011

This page is intentionally left blank